

FOREO  
SWEDEN

# LUNA™ play plus 2

FACIAL CLEANSING MASSAGER



ONLINE MANUAL

# FULL USER MANUAL

---

## GETTING STARTED

Congratulations on taking the first step toward discovering smarter skincare by acquiring LUNA™ play plus 2. Before you begin to enjoy all the benefits of sophisticated skincare technology in the comfort of your home, please take a few moments to carefully read the instructions in this manual.

Please **READ ALL INSTRUCTIONS BEFORE USE** and utilize this product only for its intended use as described in this manual.

**⚠ WARNING:** No modification of this equipment is allowed.

## LUNA™ play plus 2 OVERVIEW

Level up your skincare game by discovering the beauty of T-Sonic™ facial cleansing! Combining ultra-hygienic silicone and 8,000 T-Sonic™ pulsations per minute, this tiny but mighty device removes up to 99.5% of dirt, oil, sweat and makeup residue in just 1 minute!

Offering a gentle facial massage and three new playful colors to enjoy, LUNA™ play plus 2 ensures an effective and fun facial cleansing routine, whether you're at home or on-the-go!

## GETTING TO KNOW LUNA™ play plus 2

### THICKER TOUCHPOINTS

Increased curvature and thickness provides a deep cleanse for problematic areas such as the T-zone, and more precise cleansing for harder to reach areas.

### THINNER TOUCHPOINTS

Ultra-soft and gentle to deeply yet delicately cleanse normal and sensitive skin types, including larger areas such as the cheeks.

### 2-ZONE BRUSH HEAD

Provides effective cleansing for all skin types.

### T-SONIC™ PULSATIONS

8,000 T-Sonic™ pulsations per minute for deep and effective cleansing and relaxing facial massage.

### UNIVERSAL BUTTON

Turns the device on /off with one press.

### ULTRA-HYGIENIC SILICONE

Silky soft, quick-drying and nonporous to prevent bacteria buildup, 35x more hygienic than nylon bristles, and suitable for all skin types.

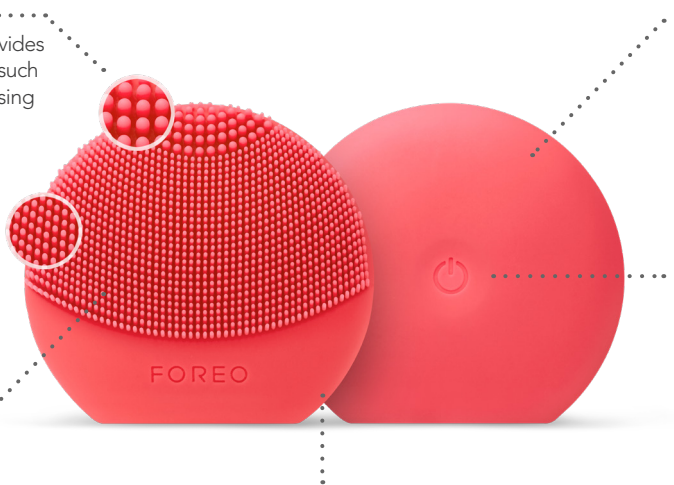

## HOW TO USE LUNA™ play plus 2



### 1. APPLY CLEANSER

Remove all makeup, dampen face and apply your regular face cleanser. Then wet LUNA™ play plus 2 and press the universal button to turn on the device.



### 2. CLEANSE

Gently press the soft silicone bristles to your skin and move the device in circular motions around your face, gliding up and down the nose, for 1 minute. Delicately massage the under-eye area by using outward strokes. Press the universal button once more to turn off the LUNA™ play plus 2.



### 3. RINSE

Press and hold the universal button again to turn off the device. Rinse and pat your face dry. Then apply any other skincare products of your choice, if desired.

## CLEANING YOUR DEVICE

Always clean your device thoroughly after use. Wash the brush surface with water and soap, then rinse with warm water. Avoid using clay-based, silicone-based or grainy cleansers, exfoliators or scrubs, as they may damage the device's soft silicone touchpoints. Pat dry with a lint-free cloth or towel. After use, we recommend spraying the device with FOREO Silicone Cleaning Spray and rinsing with warm water for optimal results.

**NOTE:** Never use cleaning products containing alcohol, petrol or acetone, as they may irritate the skin and damage the silicone.

## IMPORTANT FOR OPTIMUM SAFETY:

- If you have a skin condition or any medical concerns, please consult a dermatologist before use.
- Cleansing with LUNA™ play plus 2 should be comfortable – if you experience discomfort, discontinue use immediately and consult a physician.
- Exercise particular care when cleansing the under-eye regions and do not bring the device into contact with the eyelids or eyes themselves.
- For reasons of hygiene, we do not recommend sharing your device with anyone else.
- Avoid leaving your device in direct sunlight and never expose it to extreme heat or boiling water.
- Close supervision is necessary when this device is used by, on, or near children, as well as those with reduced physical and mental abilities.
- Discontinue use if this product appears damaged in any way. This product contains no serviceable parts.
- Given the efficiency of the FOREO cleansing routine, we recommend that you do not use LUNA™ play plus 2 for more than 3 minutes at a time.
- Use this device only for its intended use as described in this manual. If you do not find the answer to your specific question, or if you have any other questions regarding the device's operation, please visit [www.foreo.com](http://www.foreo.com)

## DISPOSAL INFORMATION

Disposal of old electronic equipment (applicable in the EU and other European countries with separate waste collection systems).



The crossed-out dustbin symbol indicates that this device should not be treated as household waste, but rather be brought to the appropriate collection point for recycling of electrical and electronic equipment. By ensuring this device is disposed of correctly, you will help prevent the potential negative consequences for the environment and human health which could be caused by inappropriate waste handling of the product. The recycling of materials will also help conserve natural resources.

For more information about the recycling of your device, please contact your local household waste disposal service or your place of purchase.

## BATTERY REMOVAL

**NOTE:** This action must only be undertaken when the device is ready to be disposed of.

This device contains a battery, which must be removed before disposal and should not be thrown away with household waste. To remove the battery, unscrew the battery cover on the base of the product. Then carefully remove the battery inside.

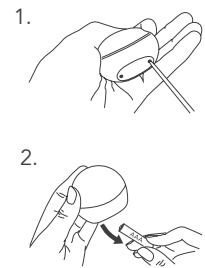

## SPECIFICATIONS

<b>MATERIALS:</b>	Body-safe silicone, PC + ABS
<b>COLOR:</b>	Peach of Cake! / I Lilac You! / Minty Cool!
<b>SIZE:</b>	60 × 65 × 30 mm
<b>WEIGHT:</b>	57g
<b>USAGE:</b>	Up to 600 uses
<b>STANDBY:</b>	180 days
<b>MAX NOISE LEVEL:</b>	<50 dB
<b>INTERFACE:</b>	1 button

## DISCLAIMER

Users of this device do so at their own risk. Neither FOREO nor its retailers assume any responsibility or liability for any injuries or damages, physical or otherwise, resulting, directly or indirectly, from the use of this device. Further, FOREO reserves the right to revise this publication and to make changes from time to time in the contents thereof without obligation to notify any person of such revision or changes.

**RF exposure statement:** This equipment complies with FCC radiation exposure limits set forth for an uncontrolled environment. The device has been evaluated to meet general RF exposure requirements. The device can be used in portable exposure conditions without restriction.

## FAQs

### 1. HOW DO I TURN MY LUNA™ play plus 2 ON?

Turn your LUNA™ play plus 2 on by pressing the universal button once.

### 2. HOW DO I TURN MY LUNA™ play plus 2 OFF?

Once you are done with your routine, press the universal button on your device once to turn it off.

### 3. HOW DO I START MY FIRST TREATMENT?

Dampen face and apply your regular face cleanser. Then wet LUNA™ play plus 2 and press the universal button to turn on the device. Gently press the soft silicone bristles to your skin and move the device in circular motions around your face, gliding up and down the nose, for 1 minute. Press and hold the universal button again to turn off the device. Rinse and pat your face dry, then apply any other skincare products of your choice, if desired.

### 4. WHAT COMES WITH MY LUNA™ play plus 2 DEVICE?

1x LUNA™ play plus 2 device, 1x basic manual.

### 5. HOW OFTEN CAN I USE MY LUNA™ play plus 2?

All LUNA™ devices are safe and gentle enough to use every day, morning or night. We recommend using your LUNA™ any time your skin needs a deep cleanse or exfoliation.

### 6. WHICH FACIAL CLEANSERS CAN BE USED WITH LUNA™ play plus 2?

You can use any facial cleanser with LUNA™ play plus 2, but to keep your device in optimal condition, avoid clay-based, silicone-based, or grainy cleansers as they may damage the silicone.

### 7. WHAT MAKES LUNA™ play plus 2 MORE EFFECTIVE THAN CLEANSING DEVICES WITH NYLON BRISTLES?

LUNA™ play plus 2 is made entirely of ultra-hygienic silicone, which is quick drying and non-porous to prevent bacteria buildup - making it 35x more hygienic than nylon bristled brushes. Featuring extra soft and smooth silicone touchpoints, LUNA™ play plus 2 gently glides across the face without pulling or stretching the skin. With the help of T-Sonic™ pulsations, LUNA™ play plus 2 provides a deep yet gentle cleanse, removing 99.5%\* of dirt, oil, sweat and makeup residue.

### 8. WHAT IS THE DIFFERENCE BETWEEN LUNA™ play plus AND LUNA™ play plus 2?

Featuring double the power, LUNA™ play plus 2 offers double the cleansing strength, for an even more effective facial cleansing routine. 30% softer silicone bristles mean that LUNA™ play plus 2 glides effortlessly across the face, with no pulling or stretching, to preserve skin's natural elasticity. Upgraded to deliver 200 more uses, LUNA™ play plus 2 now offers up to 600 uses! And to make things even more fun, LUNA™ play plus 2 is available in three beautiful new colors - Peach of Cake!, Minty Cool! and I Lilac You!

### 9. WHAT IS T-SONIC™ TECHNOLOGY?

The high-efficiency motor that powers your LUNA play plus 2 device is capable of providing more than 8,000 revolutions per minute. This high-speed movement generates subtle oscillations, which we refer to as T-Sonic pulsations. The 'T' in T-Sonic is short for transdermal - so named because these pulsations travel through the outer layers of skin, working to stimulate blood flow and loosen impurities trapped within pores.

### 10. IS LUNA™ play plus 2 SUITABLE FOR ALL SKIN TYPES?

Yes, LUNA™ play plus 2 is suitable for all skin types. The double-zone brush features two types of silicone touchpoints for optimal facial cleansing. The thinner touchpoints on the majority of the brush head are ultra-soft and gentle to deeply yet delicately cleanse normal and sensitive skin areas, including larger areas such as the cheeks. The thicker touchpoints at the top of the brush head have an increased curvature and thickness to provide a deep cleanse for problematic areas such as the T-zone, and more precise cleansing for harder to reach areas.

### 11. CAN I USE LUNA™ play plus 2 IF I HAVE SKIN CONDITIONS SUCH AS ACNE OR ECZEMA OR IF I HAVE HAD A COSMETIC PROCEDURE SUCH AS BOTOX?

We suggest that anyone who suffers from a serious skin condition or has undergone a cosmetic procedure to consult their physicians or skincare professional before using the device.

## 12. HOW DO I CLEAN MY LUNA™ play plus 2?

Wash the device with soap and water, rinse with warm water and pat dry with a lint-free cloth or towel.

We recommend spraying the device with FOREO's Silicone Cleaning Spray and rinsing with warm water afterwards for optimal results. Never use cleaning products that contain alcohol, petrol, or acetone, as they may irritate the skin.

## 13. WHAT SHOULD I DO IF MY LUNA™ play plus 2 IS NOT TURNING ON / OFF?

If LUNA™ play plus 2 is not activated when pressing the universal button, the battery may be dead. If LUNA™ play plus 2 cannot be switched off or the universal buttons do not respond, it might be that the microprocessor is temporarily malfunctioning. Press and hold the universal button to restart the device.

©2022 FOREO AB. ALL RIGHTS RESERVED.

EU DISTR.: FOREO AB, KARLAVÄGEN 41, 114 31 STOCKHOLM, SWEDEN.

US DISTR.: FOREO INC., 1525 E PAMA LANE, LAS VEGAS, NV 89119, USA.

AUS DISTR.: 6 PROHASKY STREET, PORT MELBOURNE, VIC, 3207 AUSTRALIA.

DESIGNED AND DEVELOPED BY FOREO SWEDEN.

MANUFACTURED FOR FOREO AB.

**WWW.FOREO.COM**